

DRAWING ONLY

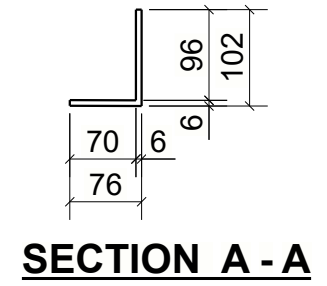
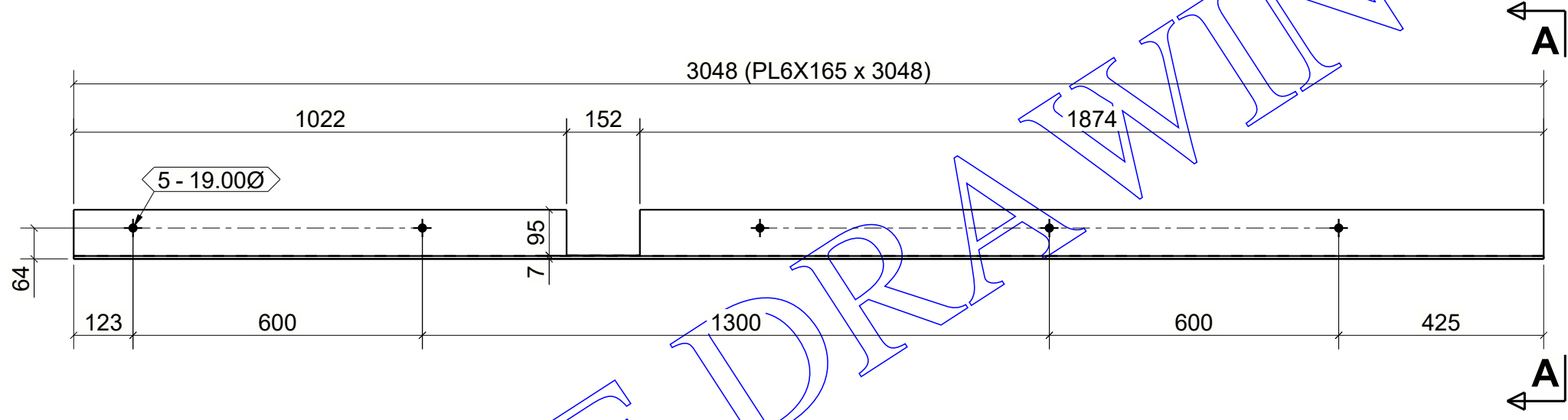

ONE - BENT PLATE - BPL4000

ASSEMBLY WEIGHT: 23lbs
 ASSEMBLY AREA: 1.06m²
 ASSEMBLY VOLUME: 0.00m³

BILL OF MATERIAL					
MARK	QTY	DESCRIPTION	LENGTH	WEIGHT	REMARKS
BPL4000	1	BENT PLATE			
BPL4000	1	PL6X165	3048.00	53	300W
TOTAL WEIGHT THIS DRAWING				53	

NOTE #1: ARCHITECT, ENGINEER & G.C. PLEASE NOTE:
 IF NO COMMENTS APPEAR ON THIS DRAWING WHEN THE DRAWING ISSUED FOR APPROVAL / REVIEW, THEN ECOSSE WELDING
 WILL ASSUME THAT ITS INTERPRETATION OF ARCHITECTURAL AND STRUCTURAL DRAWINGS IS ACCEPTABLE BY ALL PARTIES, AND FABRICATION WILL PROCEED ACCORDINGLY.
 REF:
 MATERIAL: CAN3-G40.20 & G40.21
 HOLES: 22mm Ø (U.N.O)
 WELDS: 6mm Fillet (U.N.O)
 SURF PREP: SSPC-SP2
 PRIMER NOTE: ONE COAT SHOP PRIMER
 PAINT NOTE:
 REMARKS:

PROJECT:				
CUSTOMER:				
DETAIL: BENT PLATE			SHEET #:	REV:
DRAWN BY: RSK	CHECKED BY: MAK	JOB NUMBER: 7000	DWG NUMBER: BPL4000	0
DATE:	PLOT DATE:			

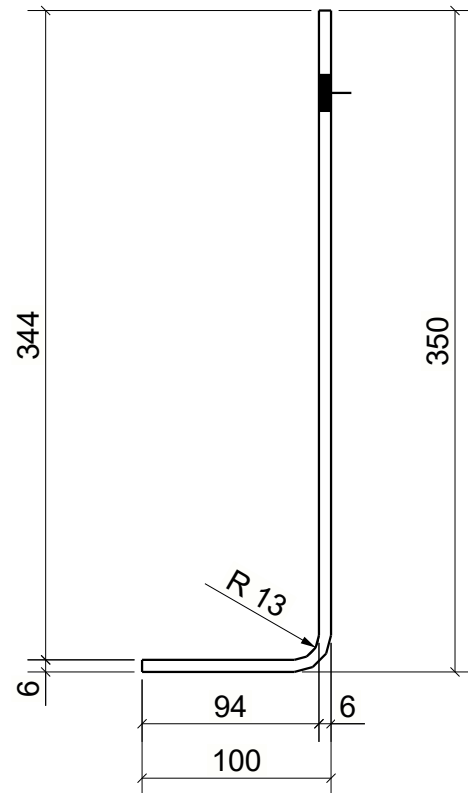

TYP.
A

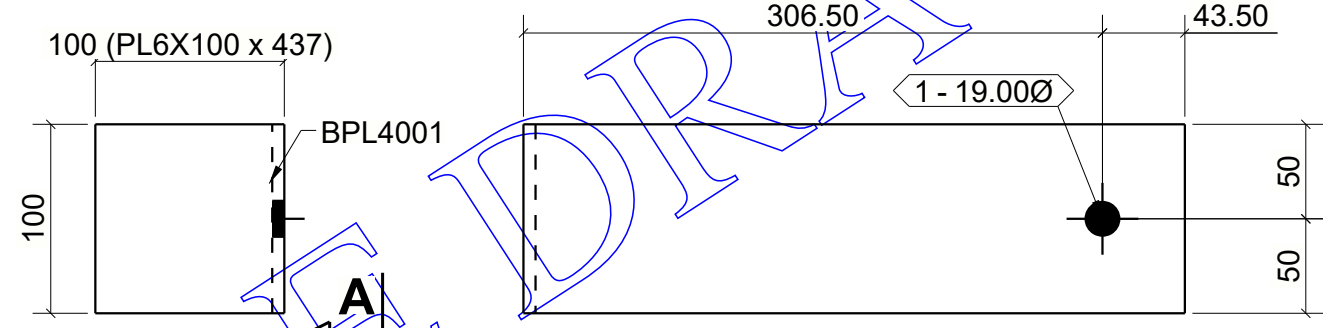

SECTION A - A

12 - BENTPLATES - BPL4001

BILL OF MATERIAL

MARK	QTY	DESCRIPTION	LENGTH	WEIGHT	REMARKS
BPL4001	12	BENTPLATES			
BPL4001	12	PL6X100	437.00	58	300W
TOTAL WEIGHT THIS DRAWING				58	

NOTE #1: ARCHITECT, ENGINEER & G.C. PLEASE NOTE:
 IF NO COMMENTS APPEAR ON THIS DRAWING WHEN THE DRAWING ISSUED FOR APPROVAL / REVIEW, THEN ECOSSE WELDING
 WILL ASSUME THAT ITS INTERPRETATION OF ARCHITECTURAL AND STRUCTURAL DRAWINGS IS ACCEPTABLE BY ALL PARTIES, AND FABRICATION WILL PROCEED ACCORDINGLY.
 REF:
 MATERIAL: CAN3-G40.20 & G40.21
 HOLES: 22mm Ø (U.N.O)
 WELDS: 6mm Fillet (U.N.O)
 SURF PREP: SSPC-SP2
 PRIMER NOTE: ONE COAT SHOP PRIMER
 PAINT NOTE:
 REMARKS:

PROJECT:			
CUSTOMER:			
DETAIL: BENT PLATE		SHEET #:	REV:
DRAWN BY: RSK	CHECKED BY: MAK	JOB NUMBER: 7000	DWG NUMBER: BPL4001
DATE:	PLOT DATE:		0

ASSEMBLY WEIGHT: 2lbs	ASSEMBLY AREA: 0.09m ²	ASSEMBLY VOLUME: 0.00m ³
--------------------------	--------------------------------------	--

Tekla Structures

SAMPLE DRAWING ONLY

DRAWING ONLY

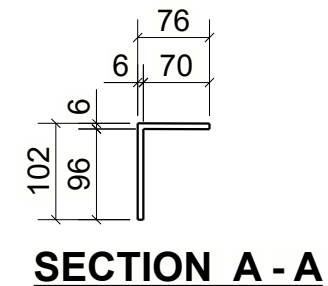
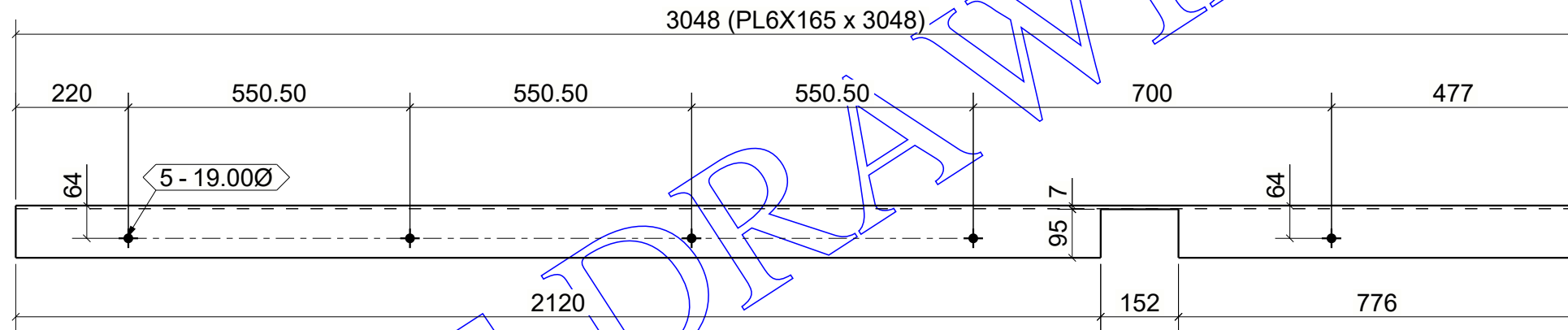

ONE - BENT PLATE - BPL4002

ASSEMBLY WEIGHT: 23lbs
 ASSEMBLY AREA: 1.06m²
 ASSEMBLY VOLUME: 0.00m³

BILL OF MATERIAL					
MARK	QTY	DESCRIPTION	LENGTH	WEIGHT	REMARKS
BPL4002	1	BENT PLATE			
BPL4002	1	PL6X165	3048.00	53	300W
TOTAL WEIGHT THIS DRAWING				53	

NOTE #1: ARCHITECT, ENGINEER & G.C. PLEASE NOTE:
 IF NO COMMENTS APPEAR ON THIS DRAWING WHEN THE DRAWING ISSUED FOR APPROVAL / REVIEW, THEN ECOSSE WELDING
 WILL ASSUME THAT ITS INTERPRETATION OF ARCHITECTURAL AND STRUCTURAL DRAWINGS IS ACCEPTABLE BY ALL PARTIES, AND FABRICATION WILL PROCEED ACCORDINGLY.
 REF:
 MATERIAL: CAN3-G40.20 & G40.21
 HOLES: 22mm Ø (U.N.O)
 WELDS: 6mm Fillet (U.N.O)
 SURF PREP: SSPC-SP2
 PRIMER NOTE: ONE COAT SHOP PRIMER
 PAINT NOTE:
 REMARKS:

PROJECT:				
CUSTOMER:				
DETAIL: BENT PLATE			SHEET #:	REV:
DRAWN BY: RSK	CHECKED BY: MAK	JOB NUMBER: 7000	DWG NUMBER: BPL4002	0
DATE:	PLOT DATE:			

DRAWING ONLY

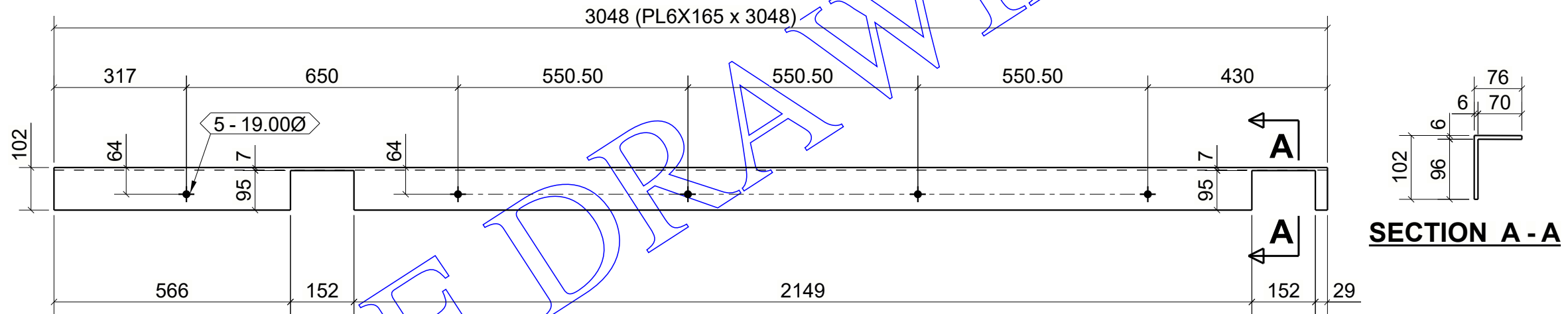

ONE - BENT PLATE - BPL4003

ASSEMBLY WEIGHT: 23lbs
 ASSEMBLY AREA: 1.03m²
 ASSEMBLY VOLUME: 0.00m³

BILL OF MATERIAL

MARK	QTY	DESCRIPTION	LENGTH	WEIGHT	REMARKS
BPL4003	1	BENT PLATE			
BPL4003	1	PL6X165	3048.00	51	300W
TOTAL WEIGHT THIS DRAWING				51	

NOTE #1: ARCHITECT, ENGINEER & G.C. PLEASE NOTE:
 IF NO COMMENTS APPEAR ON THIS DRAWING WHEN THE DRAWING ISSUED FOR APPROVAL / REVIEW, THEN ECOSSE WELDING
 WILL ASSUME THAT ITS INTERPRETATION OF ARCHITECTURAL AND STRUCTURAL DRAWINGS IS ACCEPTABLE BY ALL PARTIES, AND FABRICATION WILL PROCEED ACCORDINGLY.
 REF:
 MATERIAL: CAN3-G40.20 & G40.21
 HOLES: 22mm Ø (U.N.O)
 WELDS: 6mm Fillet (U.N.O)
 SURF PREP: SSPC-SP2
 PRIMER NOTE: ONE COAT SHOP PRIMER
 PAINT NOTE:
 REMARKS:

PROJECT:			
CUSTOMER:			
DETAIL: BENT PLATE			SHEET #:
DRAWN BY: RSK	CHECKED BY: MAK	JOB NUMBER: 7000	DWG NUMBER: BPL4003
DATE:	PLOT DATE:		REV: 0

DRAWING ONLY

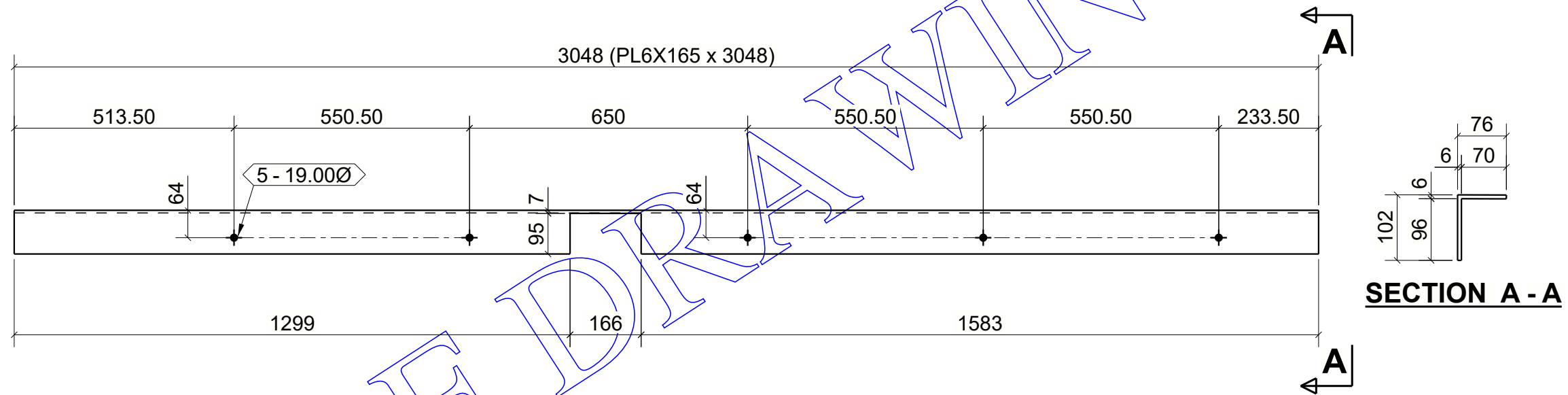

ONE - BENT PLATE - BPL4004

ASSEMBLY WEIGHT: 23lbs
 ASSEMBLY AREA: 1.06m²
 ASSEMBLY VOLUME: 0.00m³

BILL OF MATERIAL

MARK	QTY	DESCRIPTION	LENGTH	WEIGHT	REMARKS
BPL4004	1	BENT PLATE			
BPL4004	1	PL6X165	3048.00	53	300W
TOTAL WEIGHT THIS DRAWING				53	

NOTE #1: ARCHITECT, ENGINEER & G.C. PLEASE NOTE:
 IF NO COMMENTS APPEAR ON THIS DRAWING WHEN THE DRAWING ISSUED FOR APPROVAL / REVIEW, THEN ECOSSE WELDING WILL ASSUME THAT ITS INTERPRETATION OF ARCHITECTURAL AND STRUCTURAL DRAWINGS IS ACCEPTABLE BY ALL PARTIES, AND FABRICATION WILL PROCEED ACCORDINGLY.
 REF:
 MATERIAL: CAN3-G40.20 & G40.21
 HOLES: 22mm Ø (U.N.O)
 WELDS: 6mm Fillet (U.N.O)
 SURF PREP: SSPC-SP2
 PRIMER NOTE: ONE COAT SHOP PRIMER
 PAINT NOTE:
 REMARKS:

PROJECT:			
CUSTOMER:			
DETAIL: BENT PLATE			SHEET #:
DRAWN BY: RSK	CHECKED BY: MAK	JOB NUMBER: 7000	DWG NUMBER: BPL4004
			REV: 0

DRAWING ONLY

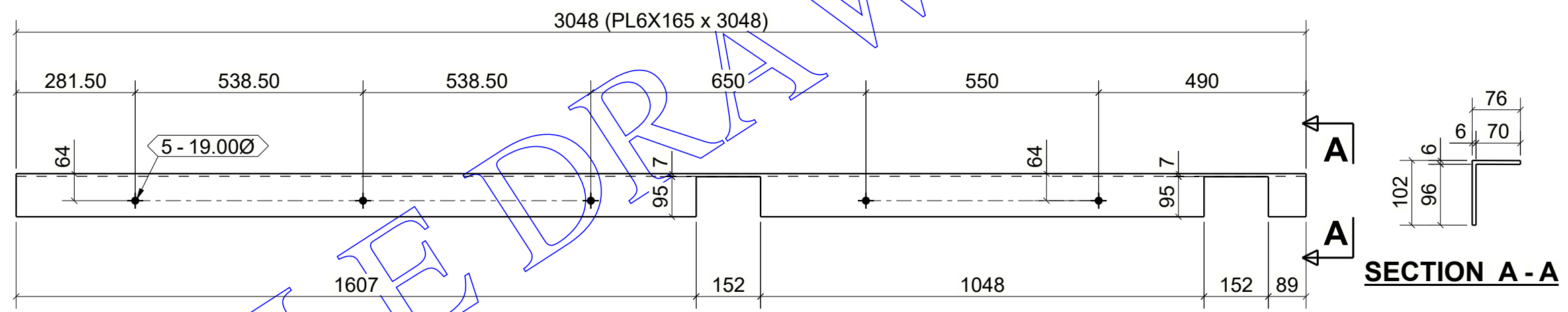

ONE - BENT PLATE - BPL4006

ASSEMBLY WEIGHT: 23lbs
 ASSEMBLY AREA: 1.03m²
 ASSEMBLY VOLUME: 0.00m³

BILL OF MATERIAL					
MARK	QTY	DESCRIPTION	LENGTH	WEIGHT	REMARKS
BPL4006	1	BENT PLATE			
BPL4006	1	PL6X165	3048.00	51	300W
TOTAL WEIGHT THIS DRAWING				51	

NOTE #1: ARCHITECT, ENGINEER & G.C. PLEASE NOTE:
 IF NO COMMENTS APPEAR ON THIS DRAWING WHEN THE DRAWING ISSUED FOR APPROVAL / REVIEW, THEN ECOSSE WELDING
 WILL ASSUME THAT ITS INTERPRETATION OF ARCHITECTURAL AND STRUCTURAL DRAWINGS IS ACCEPTABLE BY ALL PARTIES, AND FABRICATION WILL PROCEED ACCORDINGLY.
 REF:
 MATERIAL: CAN3-G40.20 & G40.21
 HOLES: 22mm Ø (U.N.O)
 WELDS: 6mm Fillet (U.N.O)
 SURF PREP: SSPC-SP2
 PRIMER NOTE: ONE COAT SHOP PRIMER
 PAINT NOTE:
 REMARKS:

PROJECT:					
CUSTOMER:					
DETAIL: BENT PLATE				SHEET #:	REV:
DRAWN BY: RSK	CHECKED BY: MAK	JOB NUMBER: 7000	DWG NUMBER: BPL4006	0	

DRAWING ONLY

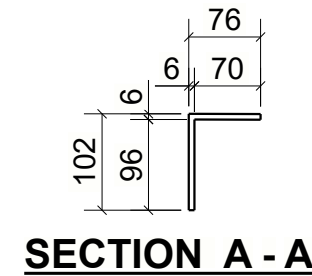
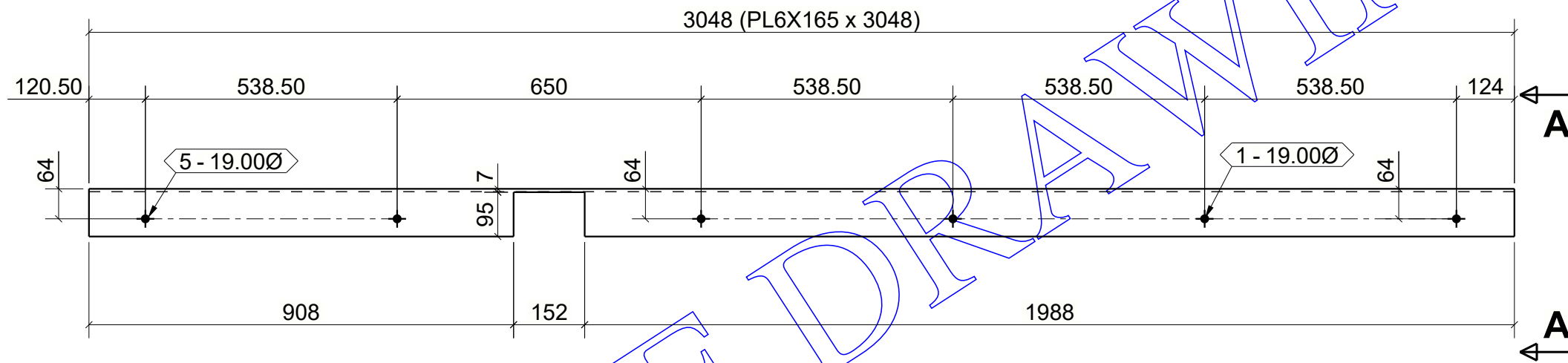

ONE - BENT PLATE - BPL4008

ASSEMBLY WEIGHT: 23lbs
 ASSEMBLY AREA: 1.06m²
 ASSEMBLY VOLUME: 0.00m³

BILL OF MATERIAL

MARK	QTY	DESCRIPTION	LENGTH	WEIGHT	REMARKS
BPL4008	1	BENT PLATE			
BPL4008	1	PL6X165	3048.00	53	300W
TOTAL WEIGHT THIS DRAWING				53	

NOTE #1: ARCHITECT, ENGINEER & G.C. PLEASE NOTE:
 IF NO COMMENTS APPEAR ON THIS DRAWING WHEN THE DRAWING ISSUED FOR APPROVAL / REVIEW, THEN ECOSSE WELDING
 WILL ASSUME THAT ITS INTERPRETATION OF ARCHITECTURAL AND STRUCTURAL DRAWINGS IS ACCEPTABLE BY ALL PARTIES, AND FABRICATION WILL PROCEED ACCORDINGLY.
 REF:
 MATERIAL: CAN3-G40.20 & G40.21
 HOLES: 22mm Ø (U.N.O)
 WELDS: 6mm Fillet (U.N.O)
 SURF PREP: SSPC-SP2
 PRIMER NOTE: ONE COAT SHOP PRIMER
 PAINT NOTE:
 REMARKS:

PROJECT:				
CUSTOMER:				
DETAIL: BENT PLATE			SHEET #:	REV:
DRAWN BY: RSK	CHECKED BY: MAK	JOB NUMBER: 7000	DWG NUMBER: BPL4008	0
DATE:	PLOT DATE:			